

GENERAL NOTES TO MAP

1. WETLAND BOUNDARY DELINEATED BY TED KOZLOWSKI.
2. SURVEY LOCATION OF TREES AND PROPERTY LINE BY LINK LAND SURVEYING.
3. PROPOSED SITE PLAN DEVELOPMENT INFORMATION FROM JOHN KARELL, P.E.
4. IDENTIFICATION OF TREE TYPES BY PAUL J. JAHNIG-WETLANDS AND SOILS CONSULTING.

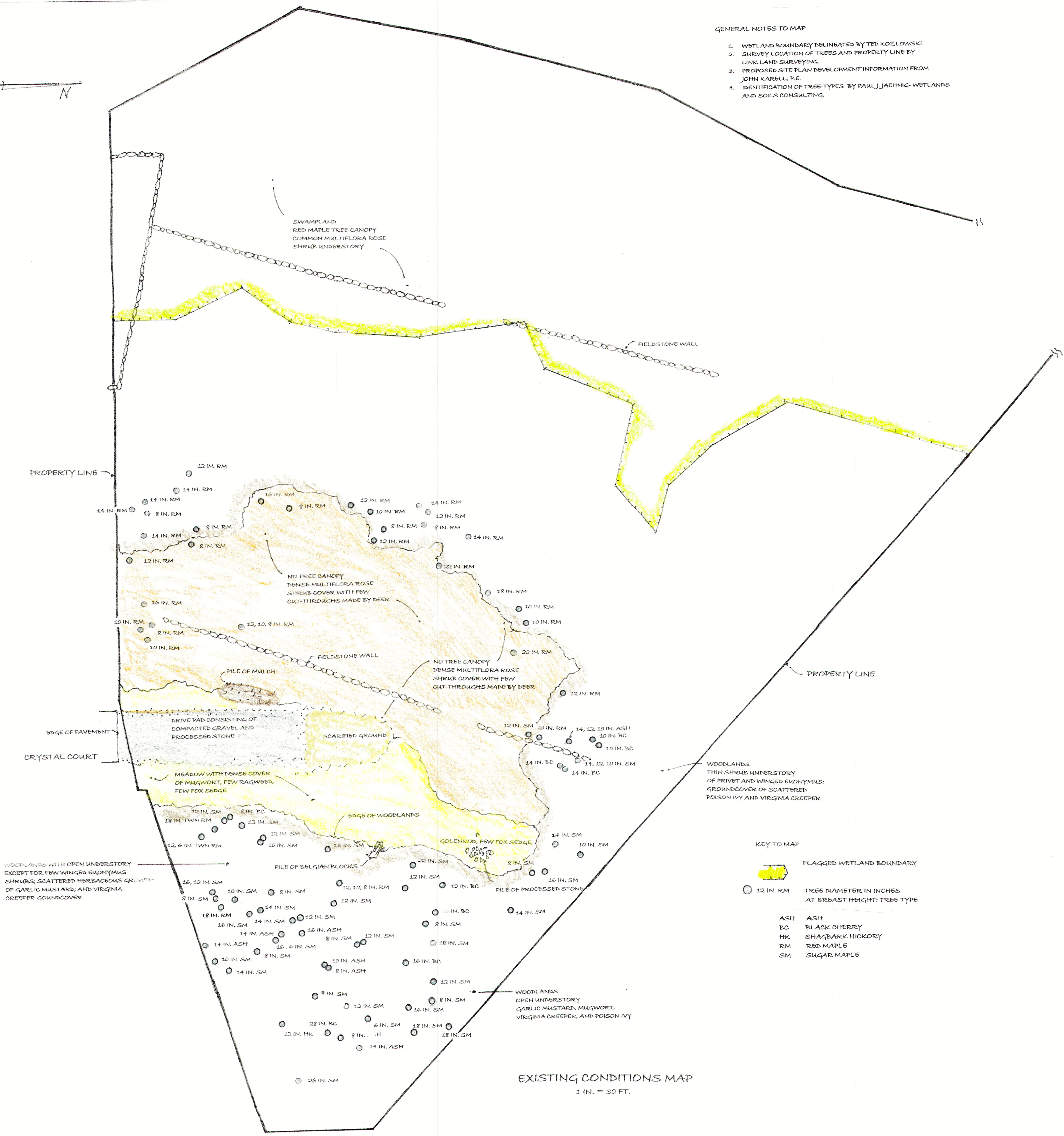

KEY TO MAP

FLAGGED WETLAND BOUNDARY

TREE DIAMETER IN INCHES AT BREAST HEIGHT; TREE TYPE

ASH ASH
 BC BLACK CHERRY
 HK SHAGBARK HICKORY
 RM RED MAPLE
 SM SUGAR MAPLE

EXISTING CONDITIONS MAP
 1 IN. = 30 FT.

REVISED AUG. 30, 2021
 TO ADDRESS LETTER DATED JULY 11, 2021
 FROM TOWN OF YORKTOWN TREE ADVISORY COMMISSION

ALTERATION OF THIS DRAWING EXCEPT BY A LICENSED ENGINEER OR ARCHITECT OR LICENSED LAND SURVEYOR IS ILLEGAL. ANY ALTERATION BY A P.E. OR ARCHITECT OR SURVEYOR MUST BE WITNESSED AND BEAR HIS SEAL, SIGNATURE AND DATE OF ALTERATION.

No.	DATE	COMMENTS
5	11-5-18	COMMENTS
4	10-15-19	COMMENTS
3	10-5-18	COMMENTS
2	5-3-18	TREE REPLACEMENT LAYOUT
1	5-31-17	PROPOSED HOUSE REVISED

JOHN KARELL, JR. P.E.
 121 CUSHMAN ROAD
 PATTERSON, NEW YORK 12563
 518-878-7894 phone
 518-878-8939 fax
 jkarell11@att.net

OWNER: **PANBAR REALTY, LLC**
 LOUIS PANNY, PRESIDENT
 CRYSTAL COURT YORKTOWN (T)

SCALE: AS SHOWN
 DATED: MAY 3, 2021
 CHECKED:

LATEST REVISION: SHEET No. EC-1

EXISTING CONDITIONS MAP
 DEPICTING LOCATION, TYPE, AND SIZE OF TREES IN PROPOSED DEVELOPMENT AREA

