

Structure Table		Structure Table	
Structure Name	Structure Details	Structure Name	Structure Details
CB-4	RM = 522.91 SUMP = 518.09 Pipe - (113) INV IN = 518.03 Pipe - (154) INV OUT = 480.80	CB-22	RM = 497.76 SUMP = 479.80 Pipe - (100) INV IN = 481.13 Pipe - (154) INV OUT = 480.80
CB-6	RM = 515.00 SUMP = 513.75 Pipe - (114) INV IN = 511.75	D4	RM = 510.96 SUMP = 506.63 Pipe - (76) INV IN = 507.53
ES-8	RM = 511.50 SUMP = 777 Pipe - (8) INV IN = 509.73	D16	RM = 497.748 SUMP = 492.560 Pipe - (76) INV IN = 483.814 Pipe - (78) INV IN = 483.659
ES-7	RM = 509.391 SUMP = 777 Pipe - (8) INV IN = 507.533	DMH-3	RM = 484.657 SUMP = 479.322 Pipe - (176) INV IN = 483.341 Pipe - (136) INV IN = 480.322
ES-2	RM = 486.156 SUMP = 777 Pipe - (124) INV IN = 483.659	CB-13	RM = 506.712 SUMP = 777 Pipe - (8) INV IN = 503.900
ES-6	RM = 506.712 SUMP = 777 Pipe - (8) INV IN = 503.900	ES-5	RM = 506.712 SUMP = 777 Pipe - (8) INV IN = 503.900
ES-5	RM = 506.712 SUMP = 777 Pipe - (8) INV IN = 503.900	CB-15	RM = 475.967 SUMP = 467.170 Pipe - (121) INV IN = 469.250 Pipe - (121) INV IN = 471.250
DD-3	RM = 475.967 SUMP = 467.170 Pipe - (121) INV IN = 469.250 Pipe - (121) INV IN = 471.250	CB-17	RM = 492.212 SUMP = 777 Pipe - (33) INV IN = 489.000
TD-1	RM = 475.967 SUMP = 467.170 Pipe - (121) INV IN = 469.250 Pipe - (121) INV IN = 471.250	CB-18	RM = 475.967 SUMP = 467.170 Pipe - (121) INV IN = 469.250 Pipe - (121) INV IN = 471.250
DMH-4	RM = 475.967 SUMP = 467.170 Pipe - (121) INV IN = 469.250 Pipe - (121) INV IN = 471.250	CB-19	RM = 475.967 SUMP = 467.170 Pipe - (121) INV IN = 469.250 Pipe - (121) INV IN = 471.250
DETONATION #1	RM = 475.967 SUMP = 467.170 Pipe - (121) INV IN = 469.250 Pipe - (121) INV IN = 471.250	CB-11	RM = 475.967 SUMP = 467.170 Pipe - (121) INV IN = 469.250 Pipe - (121) INV IN = 471.250
DMH-12	RM = 475.967 SUMP = 467.170 Pipe - (121) INV IN = 469.250 Pipe - (121) INV IN = 471.250	CB-14	RM = 475.967 SUMP = 467.170 Pipe - (121) INV IN = 469.250 Pipe - (121) INV IN = 471.250
DMH-2	RM = 501.969 SUMP = 493.969 Pipe - (167) INV IN = 496.969 Pipe - (5) INV IN = 496.655	CB-16	RM = 493.969 SUMP = 479.000 Pipe - (171) INV IN = 490.000
ES-4	RM = 497.842 SUMP = 777 Pipe - (5) INV IN = 496.655	D16	RM = 497.800 SUMP = 492.750 Pipe - (59) INV IN = 493.750
CB-25	RM = 475.967 SUMP = 467.170 Pipe - (121) INV IN = 469.250 Pipe - (121) INV IN = 471.250	CB-12	RM = 475.967 SUMP = 467.170 Pipe - (121) INV IN = 469.250 Pipe - (121) INV IN = 471.250
D1-7	RM = 476.271 SUMP = 473.967 Pipe - (133) INV IN = 473.967	CB-3	RM = 521.905 SUMP = 516.320 Pipe - (27) INV IN = 517.537 Pipe - (113) INV IN = 516.388 Pipe - (28) INV IN = 517.337
BYPASS #1	RM = 475.967 SUMP = 467.170 Pipe - (121) INV IN = 469.250 Pipe - (121) INV IN = 471.250	CB-5	RM = 514.876 SUMP = 511.210 Pipe - (128) INV IN = 509.882 Pipe - (114) INV IN = 507.727 Pipe - (25) INV IN = 508.738
DD-2	RM = 475.967 SUMP = 467.170 Pipe - (121) INV IN = 469.250 Pipe - (121) INV IN = 471.250	CB-7	RM = 506.241 SUMP = 498.240 Pipe - (30) INV IN = 498.840 Pipe - (126) INV IN = 498.584 Pipe - (31) INV IN = 497.330
DMH-6	RM = 475.967 SUMP = 467.170 Pipe - (121) INV IN = 469.250 Pipe - (121) INV IN = 471.250	CB-8	RM = 475.967 SUMP = 467.170 Pipe - (121) INV IN = 469.250 Pipe - (121) INV IN = 471.250
BYPASS #2	RM = 475.967 SUMP = 467.170 Pipe - (121) INV IN = 469.250 Pipe - (121) INV IN = 471.250	CB-10	RM = 475.967 SUMP = 467.170 Pipe - (121) INV IN = 469.250 Pipe - (121) INV IN = 471.250
CB-23	RM = 475.967 SUMP = 467.170 Pipe - (121) INV IN = 469.250 Pipe - (121) INV IN = 471.250	DMH-1	RM = 511.190 SUMP = 504.880 Pipe - (122) INV IN = 494.983 Pipe - (53) INV IN = 494.688
DMH-11	RM = 475.967 SUMP = 467.170 Pipe - (121) INV IN = 469.250 Pipe - (121) INV IN = 471.250	CB-27	RM = 543.233 SUMP = 537.487 Pipe - (143) INV IN = 538.740 Pipe - (124) INV IN = 538.740 Pipe - (144) INV IN = 538.687
DMH-10	RM = 483.140 SUMP = 476.389 Pipe - (123) INV IN = 477.330 Pipe - (150) INV IN = 477.330	CB-28	RM = 535.185 SUMP = 535.185 Pipe - (44) INV IN = 536.728 Pipe - (53) INV IN = 536.728 Pipe - (45) INV IN = 536.185
DMH-9	RM = 483.140 SUMP = 476.389 Pipe - (123) INV IN = 477.330 Pipe - (150) INV IN = 477.330	CB-29	RM = 525.080 SUMP = 525.080 Pipe - (44) INV IN = 526.330 Pipe - (47) INV IN = 518.689 Pipe - (50) INV IN = 514.640
OS-1	RM = 506.645 SUMP = 498.024 Pipe - (157) INV IN = 500.878 Pipe - (58) INV IN = 499.024	CB-30	RM = 513.389 SUMP = 513.389 Pipe - (44) INV IN = 514.640 Pipe - (47) INV IN = 518.689 Pipe - (50) INV IN = 514.640
DMH-7	RM = 483.140 SUMP = 476.389 Pipe - (123) INV IN = 477.330 Pipe - (150) INV IN = 477.330	CB-31	RM = 513.389 SUMP = 513.389 Pipe - (44) INV IN = 514.640 Pipe - (47) INV IN = 518.689 Pipe - (50) INV IN = 514.640
DMH-8	RM = 483.140 SUMP = 476.389 Pipe - (123) INV IN = 477.330 Pipe - (150) INV IN = 477.330	CB-32	RM = 513.389 SUMP = 513.389 Pipe - (44) INV IN = 514.640 Pipe - (47) INV IN = 518.689 Pipe - (50) INV IN = 514.640
D1-1	RM = 506.645 SUMP = 498.024 Pipe - (157) INV IN = 500.878 Pipe - (58) INV IN = 499.024	ES-1	RM = 513.389 SUMP = 513.389 Pipe - (44) INV IN = 514.640 Pipe - (47) INV IN = 518.689 Pipe - (50) INV IN = 514.640
D1-2	RM = 518.156 SUMP = 508.384 Pipe - (56) INV IN = 511.174 Pipe - (57) INV IN = 507.344	EX-1	RM = 543.233 SUMP = 537.487 Pipe - (143) INV IN = 538.740 Pipe - (124) INV IN = 538.740 Pipe - (144) INV IN = 538.687
D1-3	RM = 506.645 SUMP = 498.024 Pipe - (157) INV IN = 500.878 Pipe - (58) INV IN = 499.024	EX-2	RM = 535.185 SUMP = 535.185 Pipe - (44) INV IN = 536.728 Pipe - (53) INV IN = 536.728 Pipe - (45) INV IN = 536.185
CB-9	RM = 475.967 SUMP = 467.170 Pipe - (121) INV IN = 469.250 Pipe - (121) INV IN = 471.250	EX-3	RM = 525.080 SUMP = 525.080 Pipe - (44) INV IN = 526.330 Pipe - (47) INV IN = 518.689 Pipe - (50) INV IN = 514.640
CB-24	RM = 475.967 SUMP = 467.170 Pipe - (121) INV IN = 469.250 Pipe - (121) INV IN = 471.250	EX-4	RM = 513.389 SUMP = 513.389 Pipe - (44) INV IN = 514.640 Pipe - (47) INV IN = 518.689 Pipe - (50) INV IN = 514.640
CB-26	RM = 475.967 SUMP = 467.170 Pipe - (121) INV IN = 469.250 Pipe - (121) INV IN = 471.250	CB-33	RM = 513.389 SUMP = 513.389 Pipe - (44) INV IN = 514.640 Pipe - (47) INV IN = 518.689 Pipe - (50) INV IN = 514.640
CB-21	RM = 486.426 SUMP = 482.219 Pipe - (82) INV IN = 482.219	DMH-6	RM = 522.119 SUMP = 516.514 Pipe - (47) INV IN = 517.514 Pipe - (48) INV IN = 518.750
DMH-5	RM = 486.426 SUMP = 482.219 Pipe - (82) INV IN = 482.219	CB-33	RM = 524.619 SUMP = 520.260 Pipe - (48) INV IN = 521.260 Pipe - (48) INV IN = 521.511

Structure Table		Structure Table	
Structure Name	Structure Details	Structure Name	Structure Details
CL-10	RM = 496.746 SUMP = 777 Pipe - (100) INV IN = 486.582 Pipe - (154) INV OUT = 480.80	DMH-2A	RM = 500.200 SUMP = 492.200 Pipe - (154) INV IN = 495.202 Pipe - (155) INV IN = 495.202
DMH-2A	RM = 500.200 SUMP = 492.200 Pipe - (154) INV IN = 495.202 Pipe - (155) INV IN = 495.202	CL-0	RM = 502.011 SUMP = 777 Pipe - (154) INV IN = 500.708
CL-0	RM = 502.011 SUMP = 777 Pipe - (154) INV IN = 500.708	CL-1	RM = 502.245 SUMP = 777 Pipe - (154) INV IN = 500.905 Pipe - (155) INV IN = 500.908
CL-1	RM = 502.245 SUMP = 777 Pipe - (154) INV IN = 500.905 Pipe - (155) INV IN = 500.908	CL-2	RM = 517.770 SUMP = 777 Pipe - (159) INV IN = 516.546 Pipe - (159) INV IN = 516.546
CL-2	RM = 517.770 SUMP = 777 Pipe - (159) INV IN = 516.546 Pipe - (159) INV IN = 516.546	CL-3	RM = 508.476 SUMP = 777 Pipe - (160) INV IN = 508.242 Pipe - (161) INV IN = 508.242
CL-3	RM = 508.476 SUMP = 777 Pipe - (160) INV IN = 508.242 Pipe - (161) INV IN = 508.242	CL-4	RM = 506.030 SUMP = 777 Pipe - (161) INV IN = 505.396 Pipe - (159) INV IN = 505.396
CL-4	RM = 506.030 SUMP = 777 Pipe - (161) INV IN = 505.396 Pipe - (159) INV IN = 505.396	CL-5	RM = 503.343 SUMP = 777 Pipe - (162) INV IN = 502.109 Pipe - (163) INV IN = 502.109
CL-5	RM = 503.343 SUMP = 777 Pipe - (162) INV IN = 502.109 Pipe - (163) INV IN = 502.109	CL-6	RM = 502.540 SUMP = 777 Pipe - (163) INV IN = 501.307 Pipe - (164) INV IN = 501.307
CL-6	RM = 502.540 SUMP = 777 Pipe - (163) INV IN = 501.307 Pipe - (164) INV IN = 501.307	CL-7	RM = 501.276 SUMP = 777 Pipe - (164) INV IN = 500.043 Pipe - (165) INV IN = 500.043
CL-7	RM = 501.276 SUMP = 777 Pipe - (164) INV IN = 500.043 Pipe - (165) INV IN = 500.043	CL-8	RM = 500.388 SUMP = 777 Pipe - (165) INV IN = 499.155 Pipe - (166) INV IN = 499.155
CL-8	RM = 500.388 SUMP = 777 Pipe - (165) INV IN = 499.155 Pipe - (166) INV IN = 499.155	CL-9	RM = 499.247 SUMP = 777 Pipe - (166) INV IN = 498.014 Pipe - (167) INV IN = 498.014
CL-9	RM = 499.247 SUMP = 777 Pipe - (166) INV IN = 498.014 Pipe - (167) INV IN = 498.014	CL-13	RM = 505.589 SUMP = 777 Pipe - (125) INV IN = 504.424 Pipe - (125) INV IN = 504.424
CL-13	RM = 505.589 SUMP = 777 Pipe - (125) INV IN = 504.424 Pipe - (125) INV IN = 504.424	CL-14	RM = 516.007 SUMP = 777 Pipe - (126) INV IN = 514.922 Pipe - (126) INV IN = 514.922
CL-14	RM = 516.007 SUMP = 777 Pipe - (126) INV IN = 514.922 Pipe - (126) INV IN = 514.922	CL-11	RM = 497.025 SUMP = 777 Pipe - (125) INV IN = 495.861 Pipe - (126) INV IN = 495.861
CL-11	RM = 497.025 SUMP = 777 Pipe - (125) INV IN = 495.861 Pipe - (126) INV IN = 495.861		

SEWER CHART	
Structure Name	Structure Details
SMH-1	RM = 526.52' INV OUT = 521.50'
SMH-2	RM = 521.58' INV IN = 514.18' INV OUT = 513.33'
SMH-3	RM = 515.80' INV IN = 509.42' INV OUT = 509.17'
SMH-4	RM = 506.40' INV IN = 502.62' INV OUT = 502.37'
SMH-5	RM = 508.98' INV IN = 504.97' INV OUT = 504.67'
SMH-6	RM = 509.93' INV OUT = 505.75'
SMH-7	RM = 496.09' INV IN = 488.87' INV OUT = 488.62'
SMH-8	RM = 488.23' INV IN = 480.41' INV OUT = 480.16'
SMH-9	RM = 490.42' INV IN = 478.40' INV OUT = 478.15'
SMH-10	RM = 487.80' INV IN = 476.59'

**NOTE:**  
 1. THE TOWN OF YORKTOWN WILL PERIODICALLY MAINTAIN THE PROPOSED SEWER MAIN EXTENSION FOR LOW FLOW CONDITIONS.  
 2. ALL TREE SELECTED FOR REMOVAL IN THIS PROJECT ARE SELECTED PER THE NYSDOT CLAIM THE 100 SF TREE REQUIREMENT.  
 3. SANITARY SEWER SERVICE CONNECTIONS TO THE APARTMENT BUILDING AND CONDOMINIUM BUILDINGS WILL REQUIRE PRIVATE SEWER APPLICATIONS THAT WILL BE SUBMITTED TO THE HEALTH DEPARTMENT UNDER A SEPARATE COVER.

**NOTE:**  
 1. THIS IS NOT A SURVEY. ALL SURVEY INFORMATION SHOWN ON THIS PLAN HAS BEEN TAKEN FROM SURVEY MAP PREPARED BY BACEY AND WATSON, DATED 04/12/20. THE ENGINEER ASSUMES NO RESPONSIBILITY FOR ITS ACCURACY.

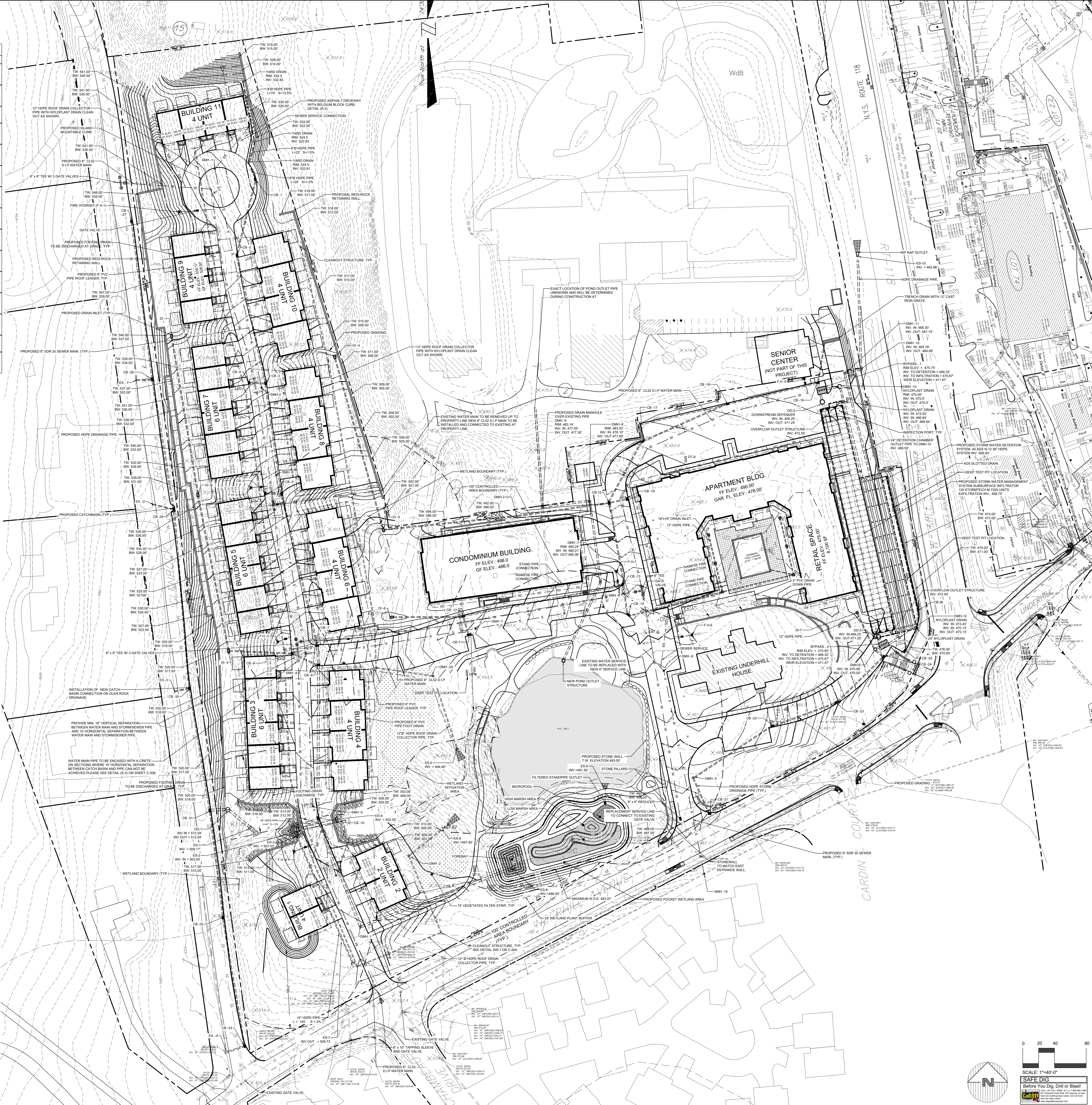

**Site Design Consultants**  
 Civil Engineers & Land Planners  
 251 F. Underhill Avenue, Yorktown, NY 10596  
 (914) 962-4888, Fax: (914) 962-2876  
 www.sitedesignconsultants.com

PROJECT - 20-20

**IMPROVEMENT PLAN**

**UNDERHILL FARM**  
 UNDERHILL AVENUE  
 Town of Yorktown

SITE PLAN  
 PREPARED FOR

SCALE: 1"=40'-0"

DATE: 6-22-20

DRY: TK

SAFE DIG  
 Before You Dig, Drill or Blast

C-105